

ASSEMBLY INSTRUCTION

BOOTY BUILDER

STANDING HIP THRUST

SELECTORIZED

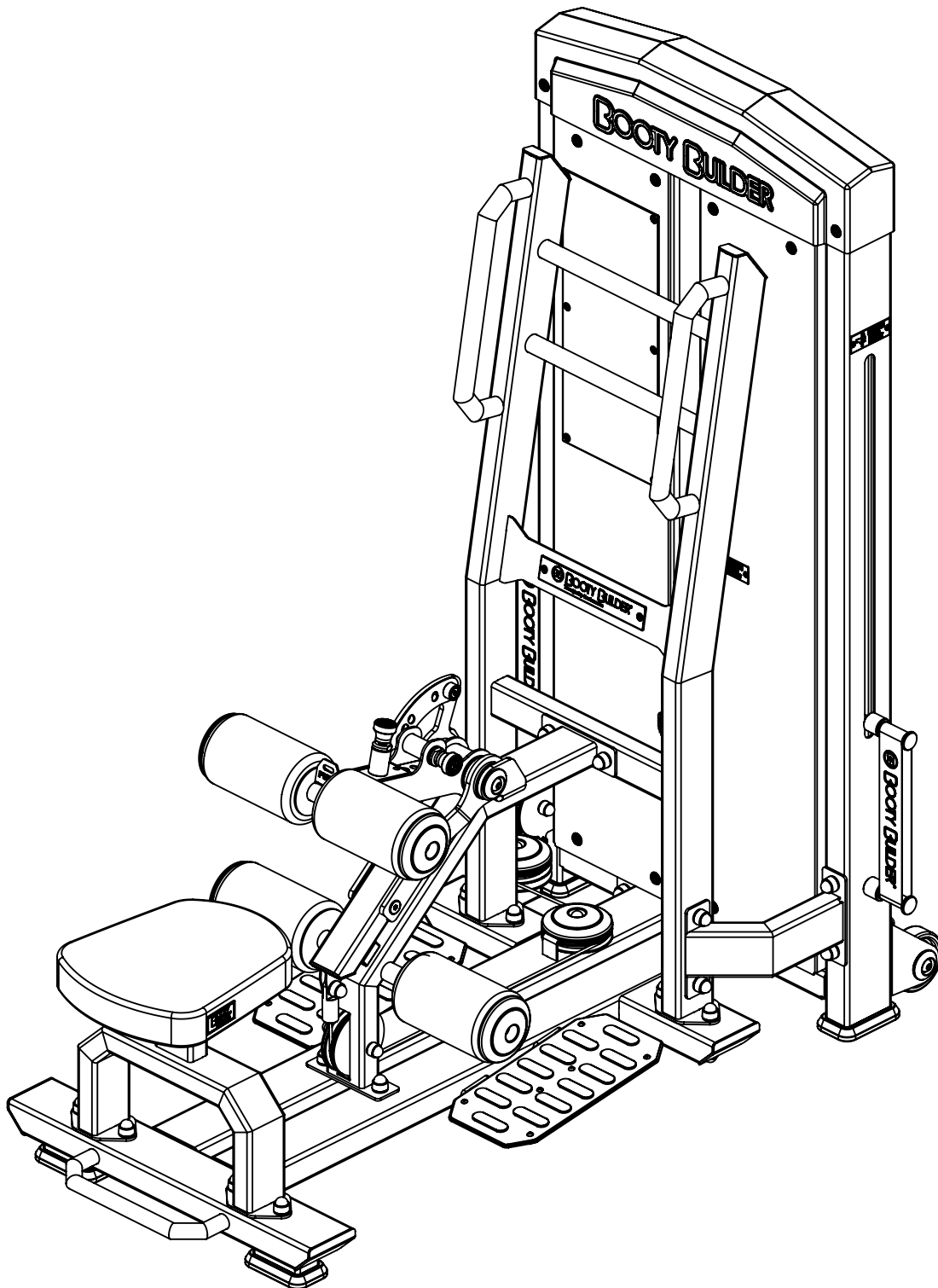

BEFORE ASSEMBLY

- **This must be read before you start assembling this unit.**
- **You must follow the assembly instructions exactly as outlined.**
- **Assemble this unit starting at the beginning and work to the end.**
- **The assembly instructions are set out so that you are only doing one section at a time, therefore you will finish one section and move on to the next.**
- **If something is missing when assembling this unit, you must notify us of the partnumber of the exact nut, bolt of part that is missing.**
- **To help you assemble this unit we have used line drawings.**
- **Check the line drawings for the exact positioning of the parts.**
- **The unit will need to be checked at least once a week for nuts and bolts that can work loose, upholstered pieces working loose and wear on pivot assemblies.**

TOOLS NEEDED

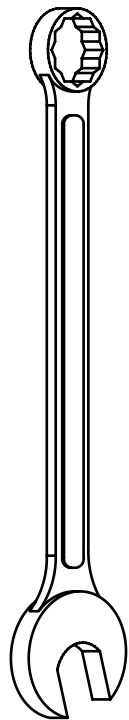

2x 19mm



8mm

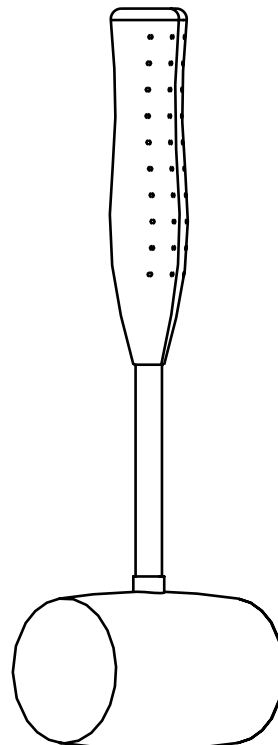

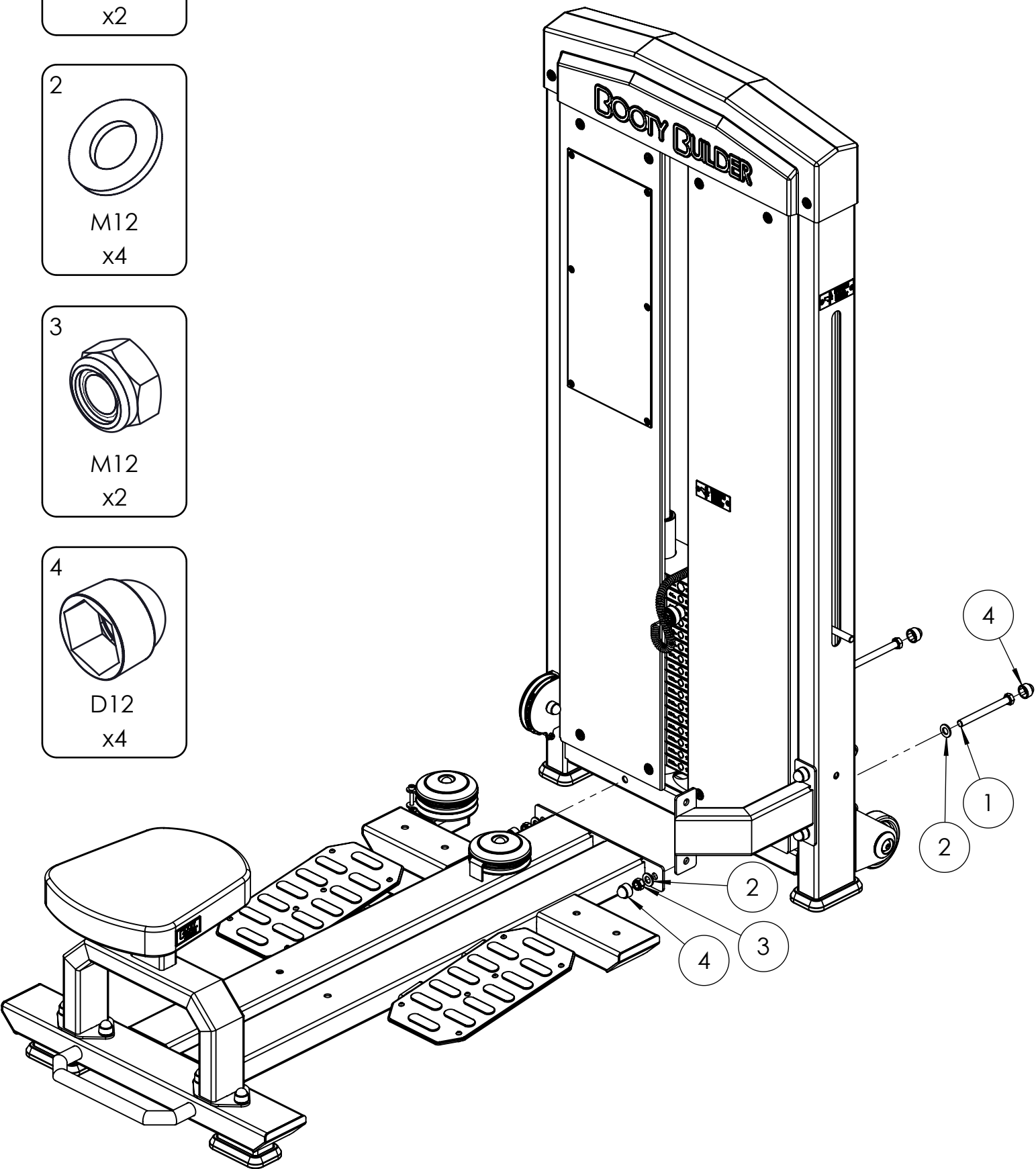
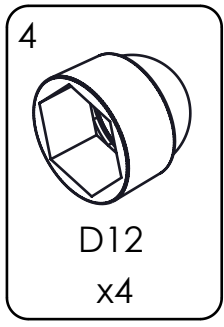
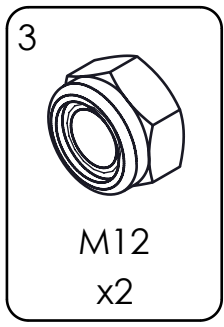
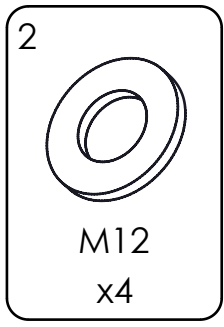
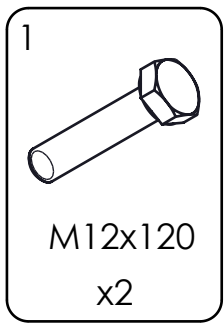

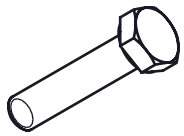
1

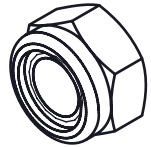
 M12x75
 x4

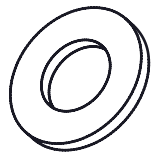
3

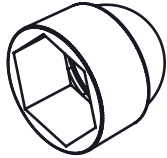
 M12
 x4

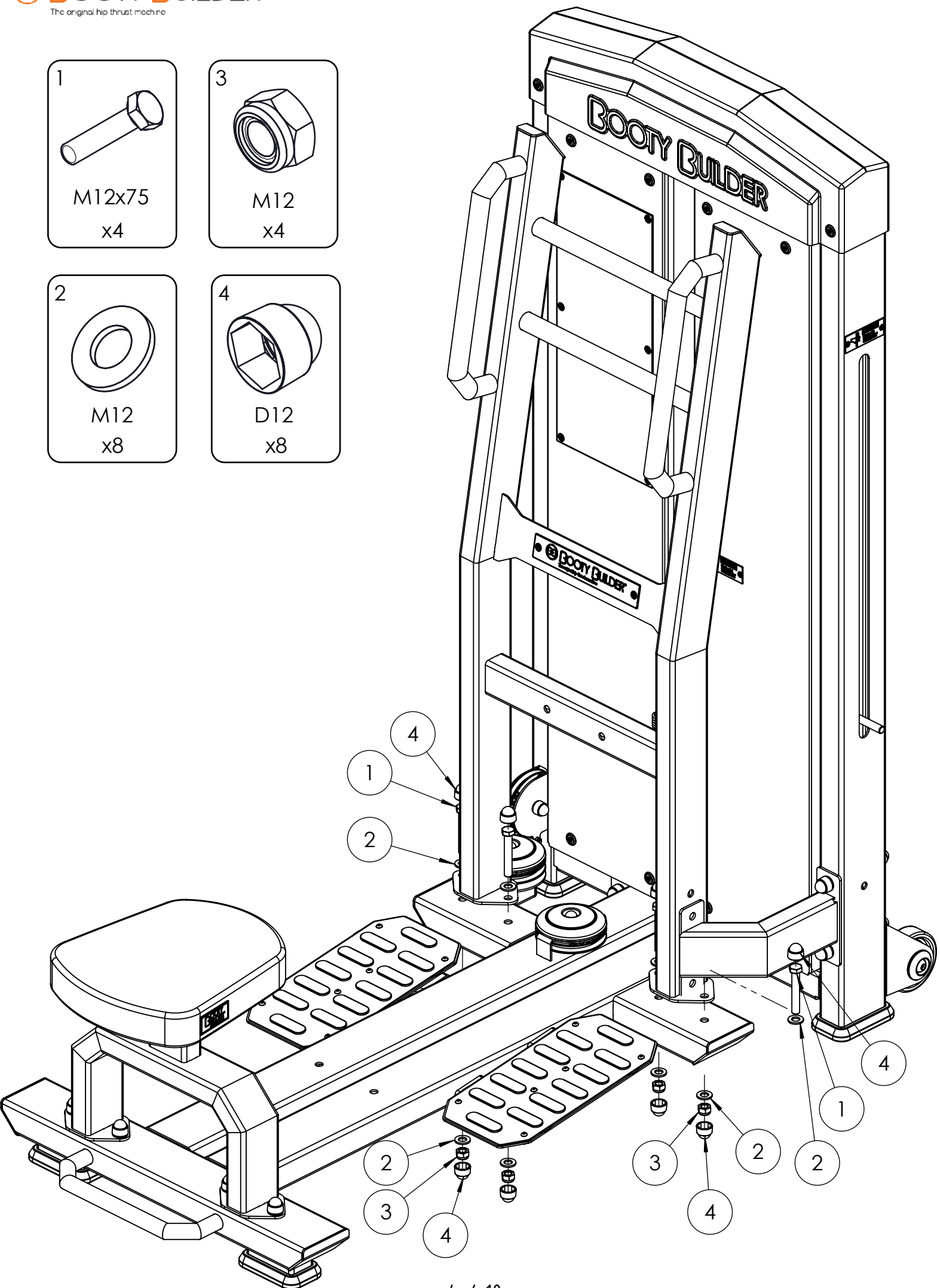
2

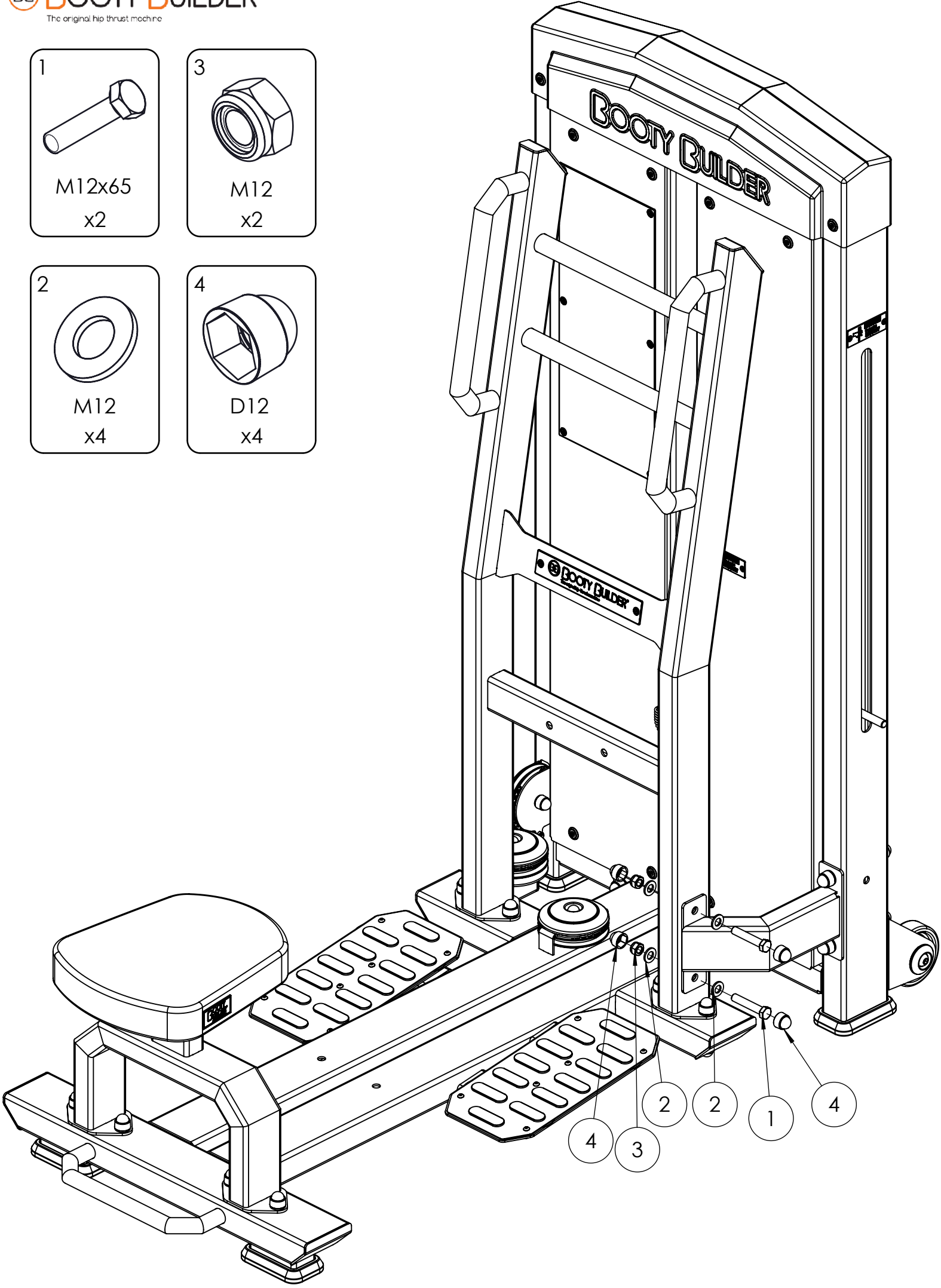
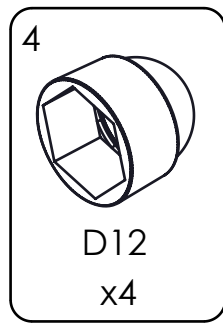
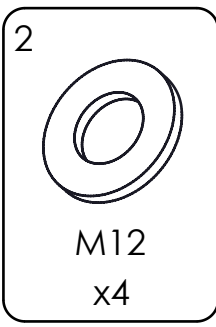
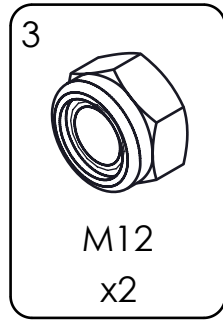
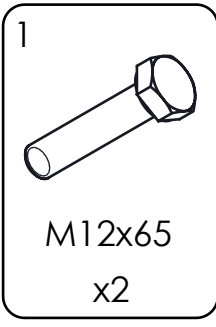
 M12
 x8

4

 D12
 x8





1
M12x75
x2

5
M12x65
x2

2
M12
x8

4
D12
x8

3
M12
x4

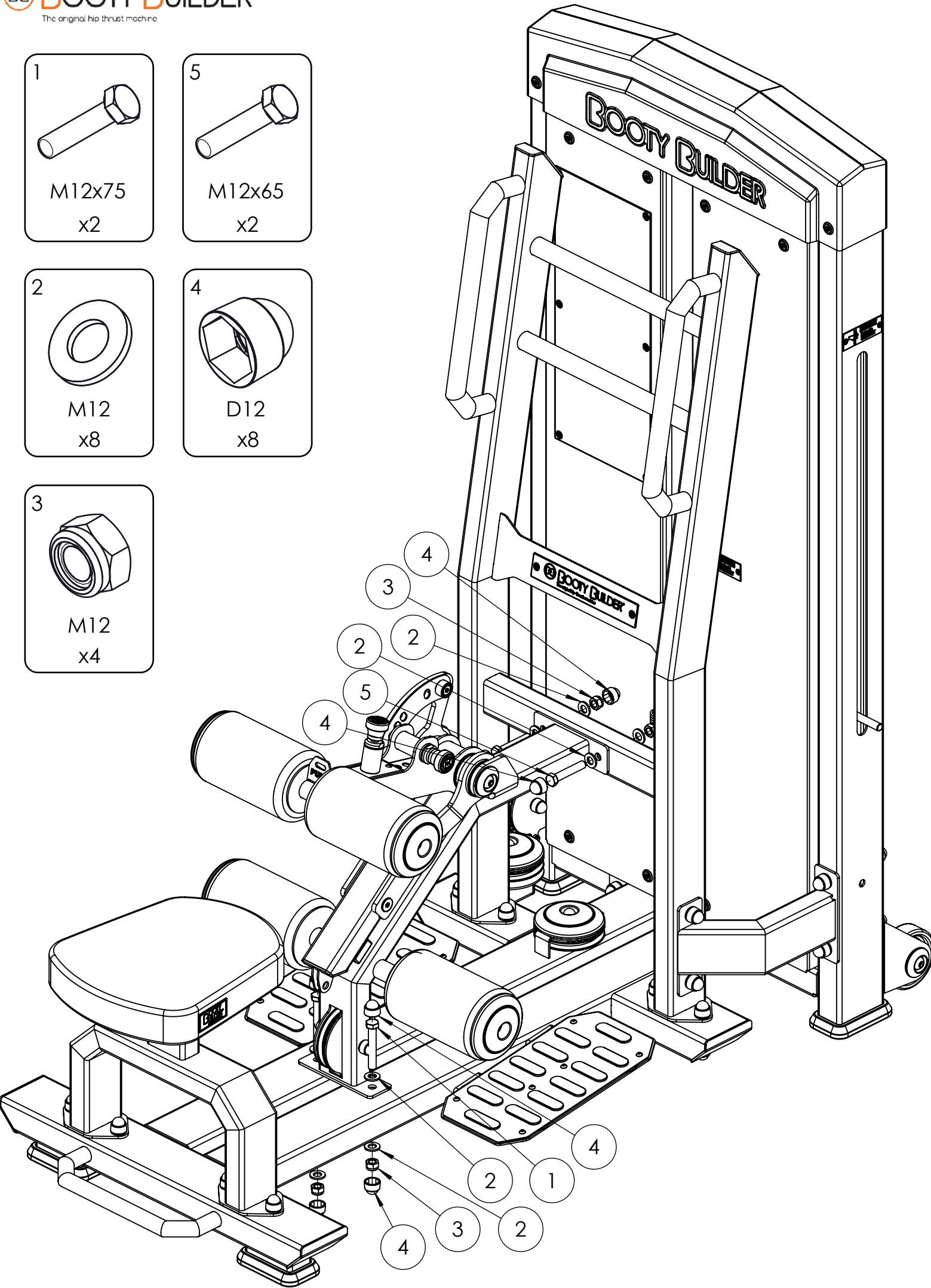

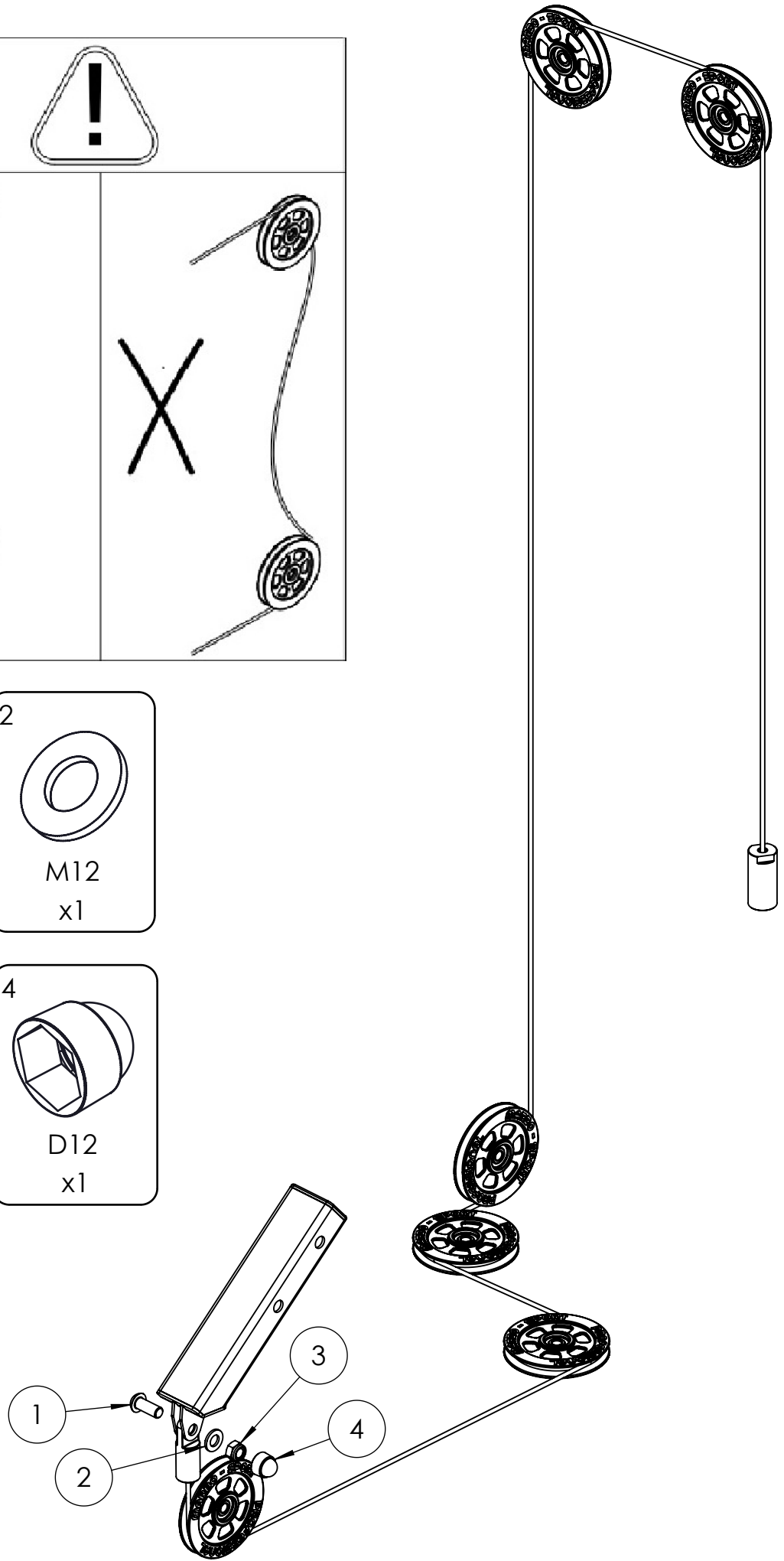
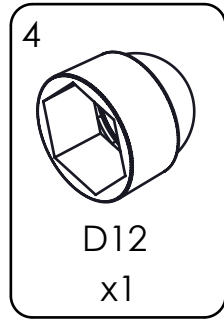
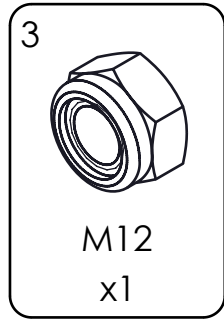
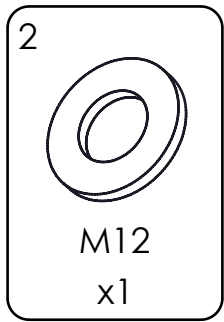
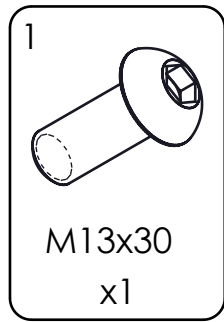
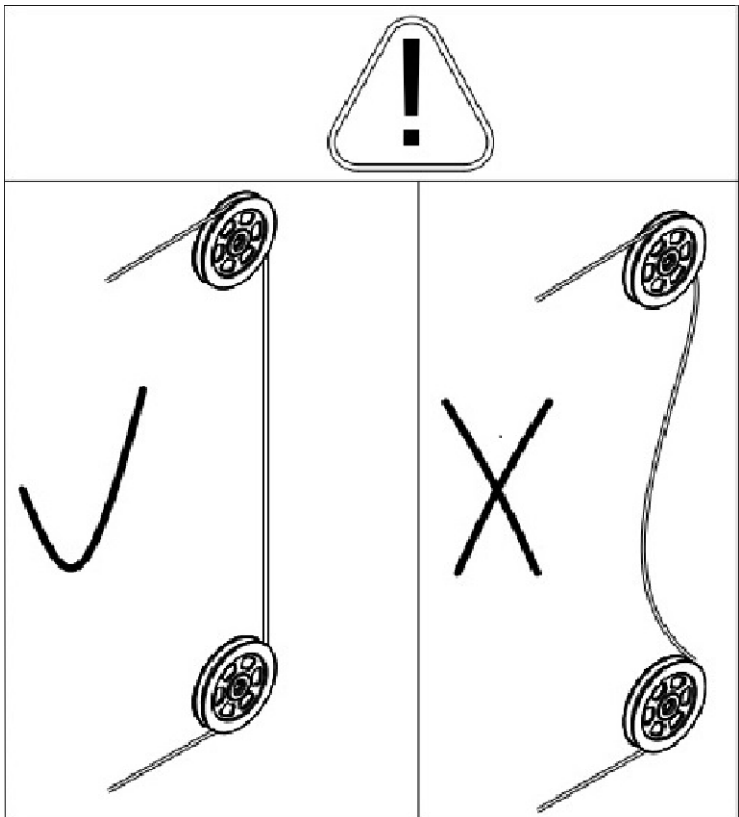

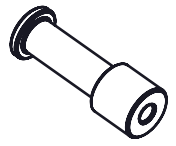
1

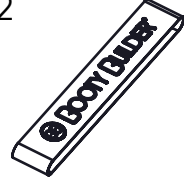
D30x88
x4

2

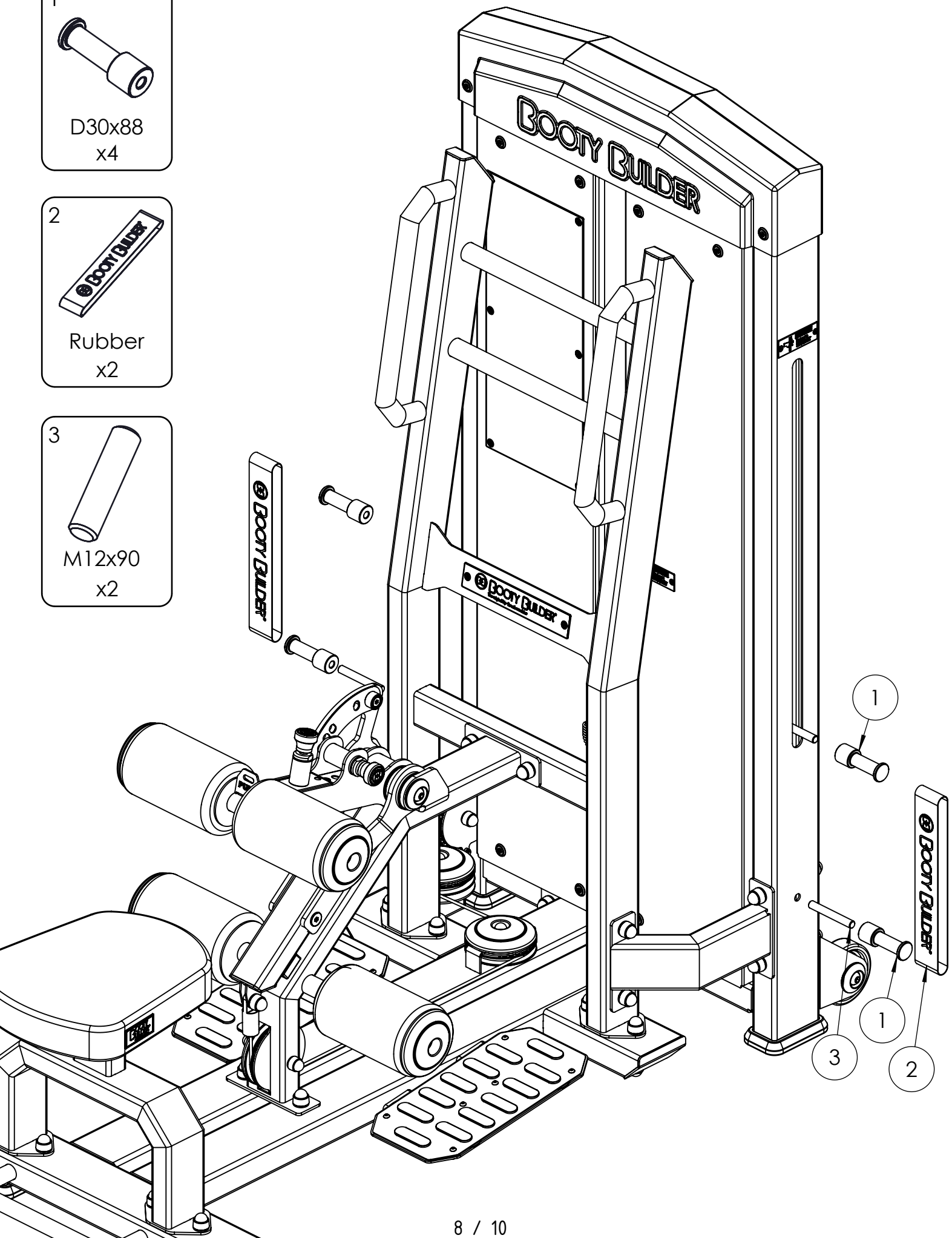
Rubber
x2

3

M12x90
x2

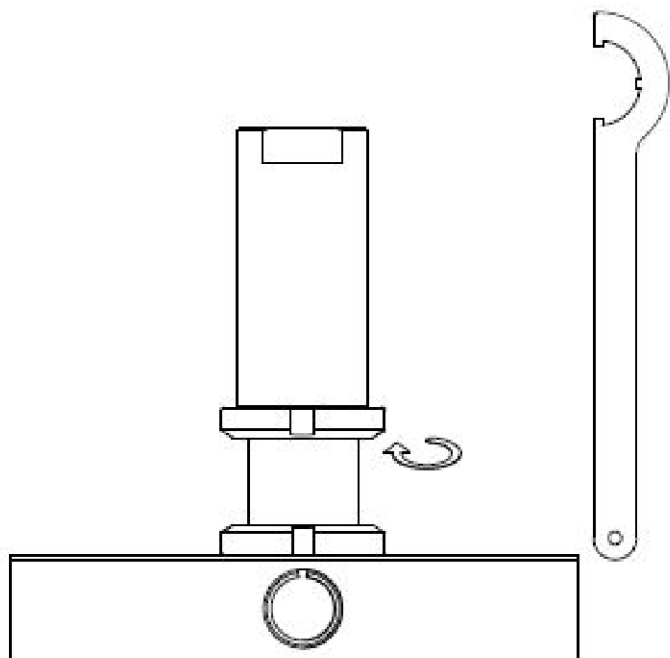

Stack cable tensioning

1



2

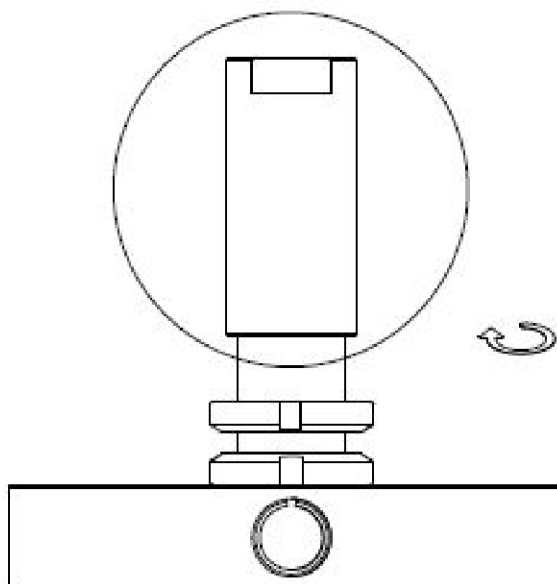

3

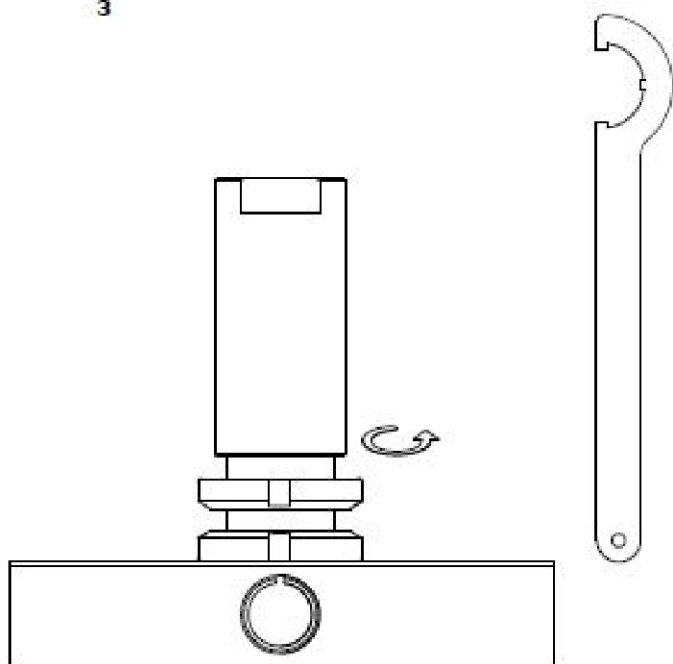

4

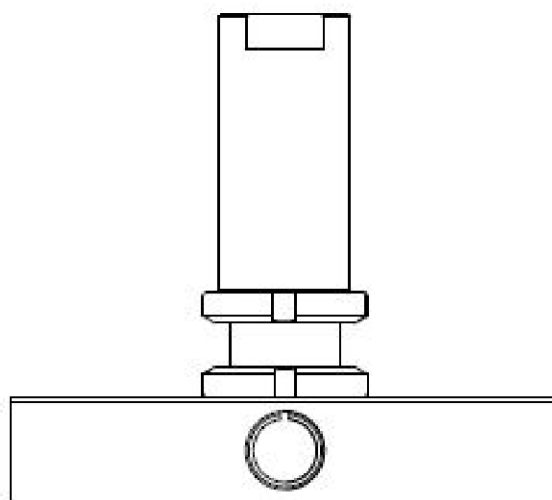



PREVENTATIVE MAINTENANCE SCHEDULE

To ensure the full safety of Booty Builder equipment for customers, the facility operator is required to periodically inspect the equipment in the gym as follows:

Monthly

- Inspect and remove any objects caught under the machine.
- Check the tension of the cables.
- Lubricate the guide rods using 3-IN-ONE oil on a cloth.
- Check for any nuts/bolts that may be loose.
- Check for any upholstered pieces that may be loose.
- Check for wear on pivot assemblies.

Every 2 Months

- Check the condition of bearings.
- Check the condition of the guide wheels.

In case of equipment failure, please report the fault to our service team by emailing serwis@marbo-sport.pl or calling +48 41 274 23 80 extension 864 and stop using the equipment until the problem is fixed